

GENERAL CHARACTERISTICS

Mechanical Pressure Switch for liquids or gaseous media. A diaphragm (low pressure) or piston (high pressure) is pre-triggered via spring with the possibility to change the spring characteristic. During the modification a switch value can be selected within a certain range.

- * good repeatability
- * high pressure
- * low hysteresis

Male thread R1/8" brass/stainless steel/steel



PM-002K004HS



PH-002M004HS

TECHNICAL DATA

	R	Type	PN bar	adjustable range bar (rel.)	tolerance (25°C) bar	hysteresis (25°C) bar	operation principle	weight kg
brass	R1/8"	P.-002M004H.	80	0.15- 2	±0.2	0.15	diaphragm	0.08
		P.-010M004H.	80	2 - 10	±0.3	0.2	diaphragm	
steel	R1/8"	P.-020S004H.	300	10 - 20	±0.4	0.3	diaphragm	0.08
		P.-050S004H.	300	20 - 50	±1.0	0.8	diaphragm	
		P.-080S004H.	300	50 - 80	±2.0	5.5	diaphragm	
		P.-150S004H.	300	50 - 150	±5.0	10	piston	
stainless steel	R1/8"	P.-002K004H.	80	0.15- 2	±0.2	0.15	diaphragm	0.08
		P.-010K004H.	80	2 - 10	±0.3	0.2	diaphragm	
		P.-020K004H.	150	10 - 20	±0.4	0.3	diaphragm	
		P.-050K004H.	150	20 - 50	±1.0	0.8	diaphragm	
		P.-080K004H.	150	50 - 80	±2.0	5.5	diaphragm	
		P.-150K004H.	150	50 - 150	±5.0	10	piston	

Adjustable range is indicated for increasing pressure.

media temperature max. 60°C

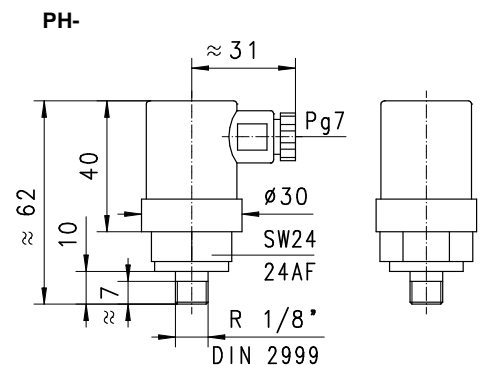
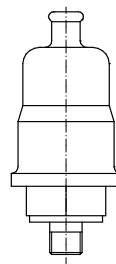
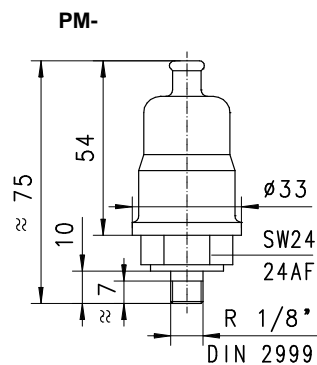

MATERIALS

	P.-002M to P.-010M	P.-020S to P.-150S	P.-...K..
body	brass	steel	stainless steel
diaphragm	NBR	NBR	NBR
piston	-	NBR	NBR
spring	s.s. 1.4310	s.s. 1.4310	s.s. 1.4310
cap /Typ PM	NBR	NBR	NBR
cap /Typ PH	nylon	nylon	nylon

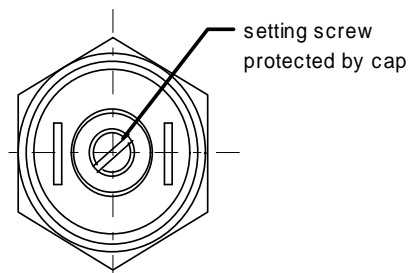

ELECTRICAL DATA

mechanical switch
48 V AC 0.5 A (0.2A inductive)
Typ PM- : plug 6.3 DIN 46224 form A
protection class IP 54
Typ PH- : induction clamp
protection class IP 65

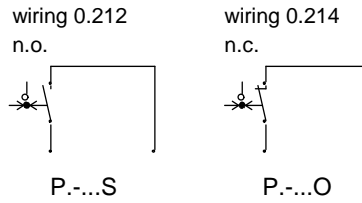

MOUNTING POSITION

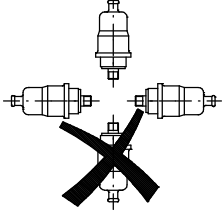

METERING SUBSTANCES

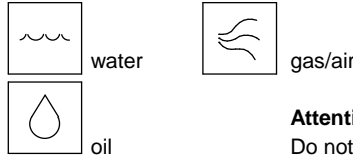

Attention!
Do not use steel
body for water

NOMENCLATURE

For combinations see table "technical data"

PM-	002	M	004	H	S	basic type specification
PM-						● pressure switch with rubber cap
PH-						● pressure switch with plastic cap
	002					● adjustable range 0.15 - 2 bar (rel.)
	010					● 2 - 10 bar (rel.)
	020					● 10 - 20 bar (rel.)
	050					● 20 - 50 bar (rel.)
	080					● 50 - 80 bar (rel.)
	150					● 50 - 150 bar (rel.)
		M				● brass design (only 2 to 10 bar)
		S				● steel design (only 20 to 150 bar)
		K				● stainless steel design
			004			● connection thread R1/8"
				H		● socket thread
					S	● wiring 0.212 n.o.
					O	● wiring 0.214 n.c.
Programme option BASIC						□ mebran viton

All technical changes reserved

●BASIC Standard ○BASIC Programme option □VARIO Special option ⊕ PLUS Accessories ✗not recommendable